



# Mono-crystalline M10(9BB) Solar Module

## RD550M10H (144 Half Cells )

Max 550Wp Output Power

Max system voltage 1500V standard

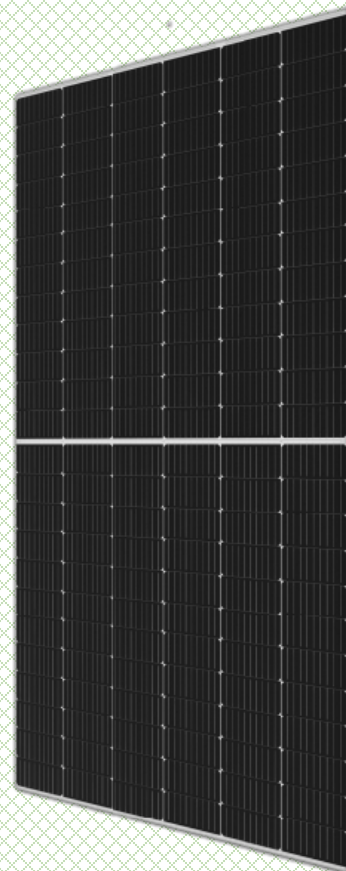

### Key Features

- Outstanding Performance in weak-light conditions
- Excellent temperature coefficient
- 0~+5W positive tolerance guarantee reliable power output
- Shortened current collection, path, low series resistance
- More uniform stress distribution, higher anti-crack ability
- Excellent anti-PID module design
- Certified to withstand high wind loads(2400pa) and snow loads(5400pa) of the latest standard test of module mechanical load
- Salt mist and ammonia corrosion resistant

### Quality & Environment Certification System

ISO 9001:2015 Quality management systems



ISO 14001:2015 Environment management systems



OHSAS 18001:2007 Occupational health and safety management systems



IEC61215

IEC61730

UL1703

IEC61701

IEC62716

### Linear Warranty For Module

15 15-year materials and workmanship Warranty

30 30-year linear performance Warranty

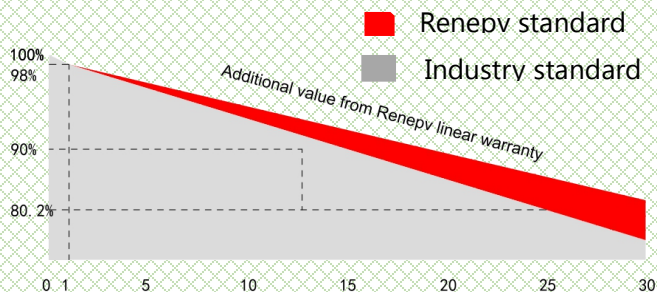

NINGBO RENELED NEW ENERGY CO.,LTD

Add:NO.35 jintong road,binhai industrial park,xiangshan,ningbo city,china

Tell: +86-574-65786319

Fax: +86-574-65786317

Email: [info@renewpv.com](mailto:info@renewpv.com)

Website: [www.renewpv.com](http://www.renewpv.com)





# Mono-crystalline M10(9BB) Solar Module

## Electrical Data (STC)

Module Type	RD550M10H	
Power output	W	550
Module efficiency	%	21.1
Voltage at Pmax	V	41.7
Current at Pmax	A	13.19
Open circuit voltage $\pm 3\%$	V	49.9
Short circuit current $\pm 3\%$	A	13.86

STC: 1000W/m<sup>2</sup> irradiance, 25°C cell temperature, AM1.5g spectrum according to EN 60904-3. Average relative efficiency reduction of 5% at 200W/m<sup>2</sup> according to EN 60904-1.

## Electrical Data (NOCT)

Module Type	RD550M10H	
Power output	W	424
Voltage at Pmax	V	37.6
Current at Pmax	A	11.28
Open circuit voltage	V	45.7
Short circuit current	A	11.68

NOCT: open-circuit module operation temperature at 800W/m<sup>2</sup> irradiance, 20°C ambient temperature, 1m/s wind

## Mechanical Data

Cell (quantity)	Mono182 72PCS
Sealing material	EVA
Back sheet	White sheet
Front Cover (material / thickness)	low-iron tempered glass / 3.2mm
Frame material	anodized aluminum alloy
Junction box (protection degree)	$\geq$ IP67 with bypass-diode
Cable (length / cross sectional area)	4.0mm <sup>2</sup>
Plug connector (type/protection degree)	MC4 / IP68
Application Classification (IEC 61730)	Class A

## Working Conditions & Temperature

Nominal operating cell temperature	NOCT	44°C $\pm$ 2°C
Temperature coefficient of P <sub>max</sub>	$\delta$ [%/°C]	-0.37
Temperature coefficient of V <sub>OC</sub>	$\beta$ [%/°C]	-0.30
Temperature coefficient of I <sub>SC</sub>	$\alpha$ [%/°C]	0.04
Maximum system voltage (IEC)	VDC	1500
Maximum series fuse rating	A	25
Operating & Storage temperature	°C	-40~+85

## Dimensions of PV Module (mm)

Module Dimension	2278×1133×35 mm
Weight	28.6kg

Unit:mm

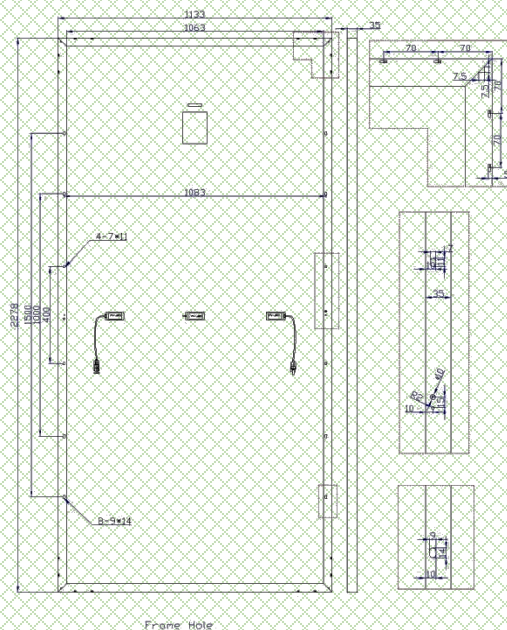

Frame Hole

## IV-Curves

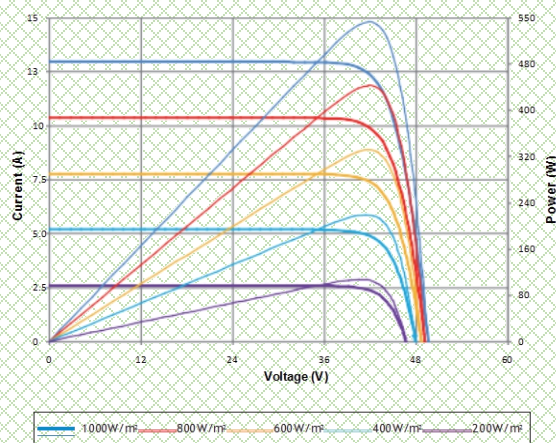

## Packing

Packing Pieces per container		
packing unit	20'GP	40'GP
Pieces per pallet	/	30
Pallet per container	/	20
Pieces per container		600